

## LI- J1010-FEEDTHROUGH

Precision is  
our business



### APPLICATION

CMS has available a wide range of products of quartz glass light guides. The LI-J1010-FEEDTHROUGH light guide is assembled by one single fibre with 600  $\mu$  m diameter. The end is terminated with an SMA connector and a SMA socket. A flexible part allows an easy connection to other systems.

Different types and length are available on request.

### SPECIFICATION

Acceptance cone angle 25°  
Material Suprasil® 200 nm up to the NIR  
Material Infrasil® 350 nm up to 2400 nm

### Physical data

Single fibre diameter 600  $\mu$  m (standard SMA) others on request  
Length 70 mm  
Mechanical connector SMA and SMA socket; others on request

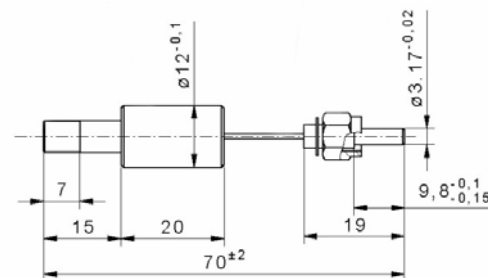

CMS - Ing. Dr. Josef Schreder  
Eggerstrasse 8  
6322 Kirchbichl  
AUSTRIA

Tel: 0043 / (0)5332 / 77056  
Fax: 0043 / (0)5332 / 76692  
E-Mail: [info@schreder-cms.com](mailto:info@schreder-cms.com)